

# FERRULE CLAMP ASME BPE - BS 4825

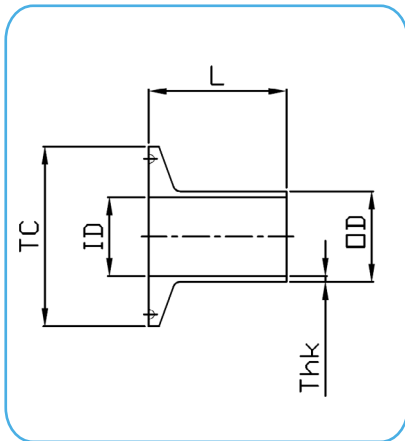

**FERRULE CLAMP  
ASME BPE  
DT-4.1.4-1**

### Technical Information:

**Connections:** Tri-Clamp according to ASME BPE (latest ed.)

**Material:** AISI 316L – 1.4404

**Internal Surface Finish:** SF1 Ra<=0.5µm → code **13** e.g.: L14AM7-A050-**13A**

**Optional:** SF4 Ra<=0.38µm Electropolish → code **43** e.g.: L14AM7-A050-**43A**

CODE	Size inch	ØTC (mm)	OD X Thk (mm)	ID (mm)	L SHORT	L MEDIUM	L LONG
					(#) <b>14WMP</b>	(#) <b>L14AM7</b>	(#) <b>S14AM</b>
(#) -A050...	1/2"	25	12.7 x 1.65	9.4	12.7	28.6	44.5
(#) -A075...	3/4"	25	19.05 x 1.65	15.75	12.7	28.6	44.5
(#) -A100...	1"	50.5	25.4 x 1.65	22.1	12.7	28.6	44.5
(#) -A150...	1" 1/2	50.5	38.1 x 1.65	34.8	12.7	28.6	44.5
(#) -A200...	2"	64	50.8 x 1.65	47.5	12.7	28.6	57.2
(#) -A250...	2" 1/2	77.5	63.5 x 1.65	60.2	12.7	28.6	57.2
(#) -A300...	3"	91	76.2 x 1.65	72.9	12.7	28.6	57.2
(#) -A400...	4"	119	101.6 x 2.10	97.4	15.9	28.6	57.2
(#) -A600...	6"	167	152.4 x 2.80	146.8	19.05	38.1	76.2

### Technical Information:

**Connections:** Tri-Clamp according to BS 4825

**Material:** AISI 316L – 1.4404

**Internal Surface Finish:** Ra<=0.5µm → code **13** e.g.: 14WLMO-A800-**13A**

CODE	Size inch	ØTC (mm)	OD X Thk (mm)	ID (mm)	L (mm)
14WLMO-A800-13A	8"	217.7	203.2 x 2.70	197.8	28
14WLMO-AA10-13A	10"	268.5	254.0 x 2.70	248.6	28
14WLMO-AA12-13A	12"	319.3	304.8 x 2.70	299.4	28

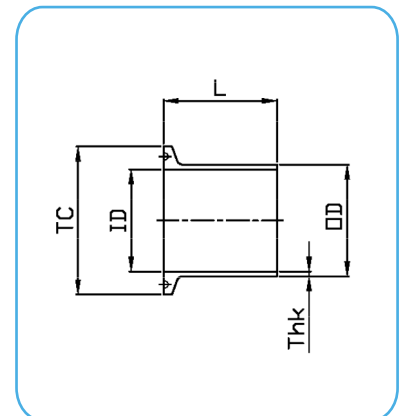

**FERRULE CLAMP  
BS 4825**

### DATASHEETS



Last updates can be found on our website - [www.aerreinox.it](http://www.aerreinox.it)  
In the interests of development of the product, we reserve the right to change the specifications without prior notice